

Display Assy

Serials Starting: Dxxxxx

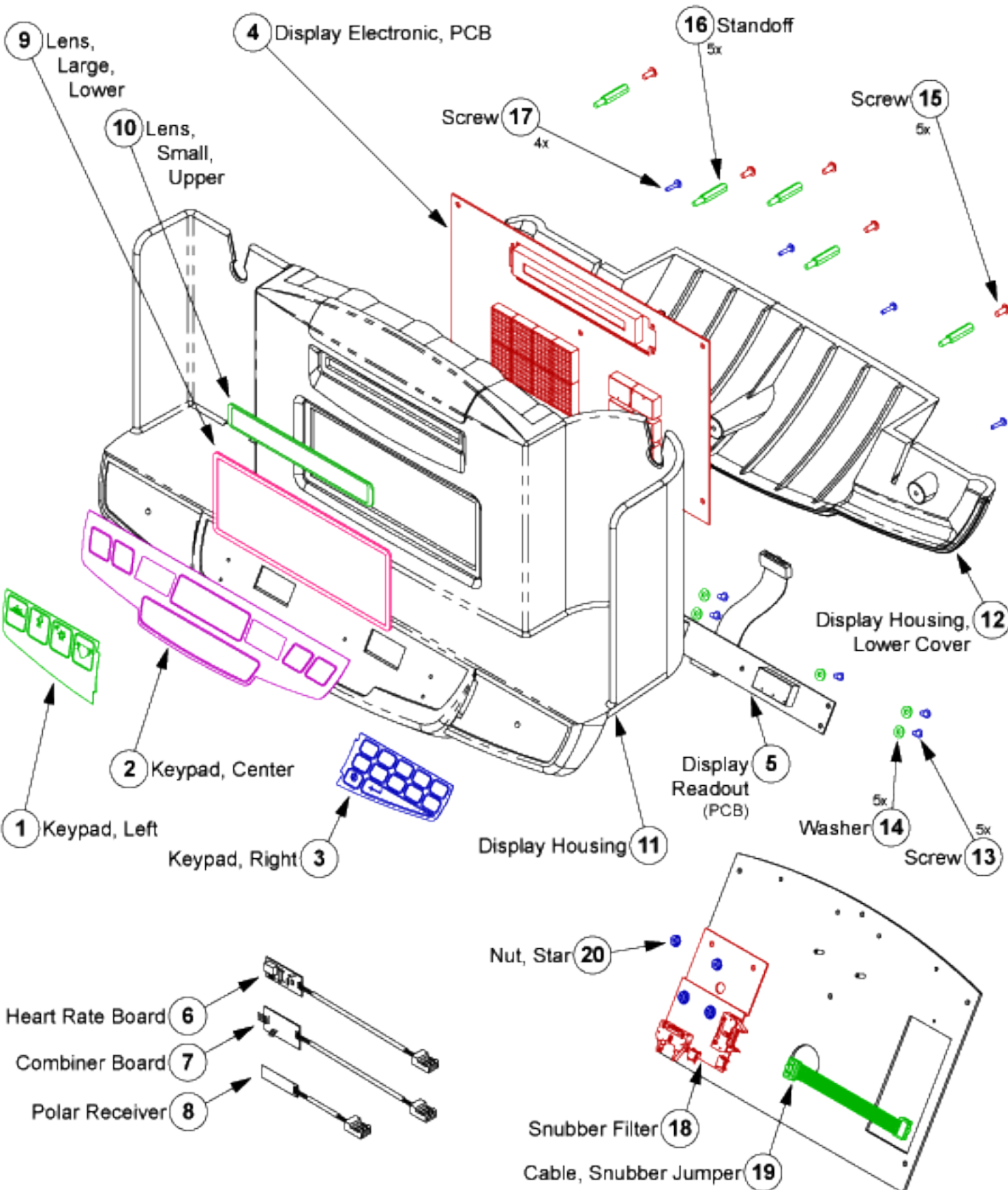

Electrical Assy
Serial Starting: Dxxxxx

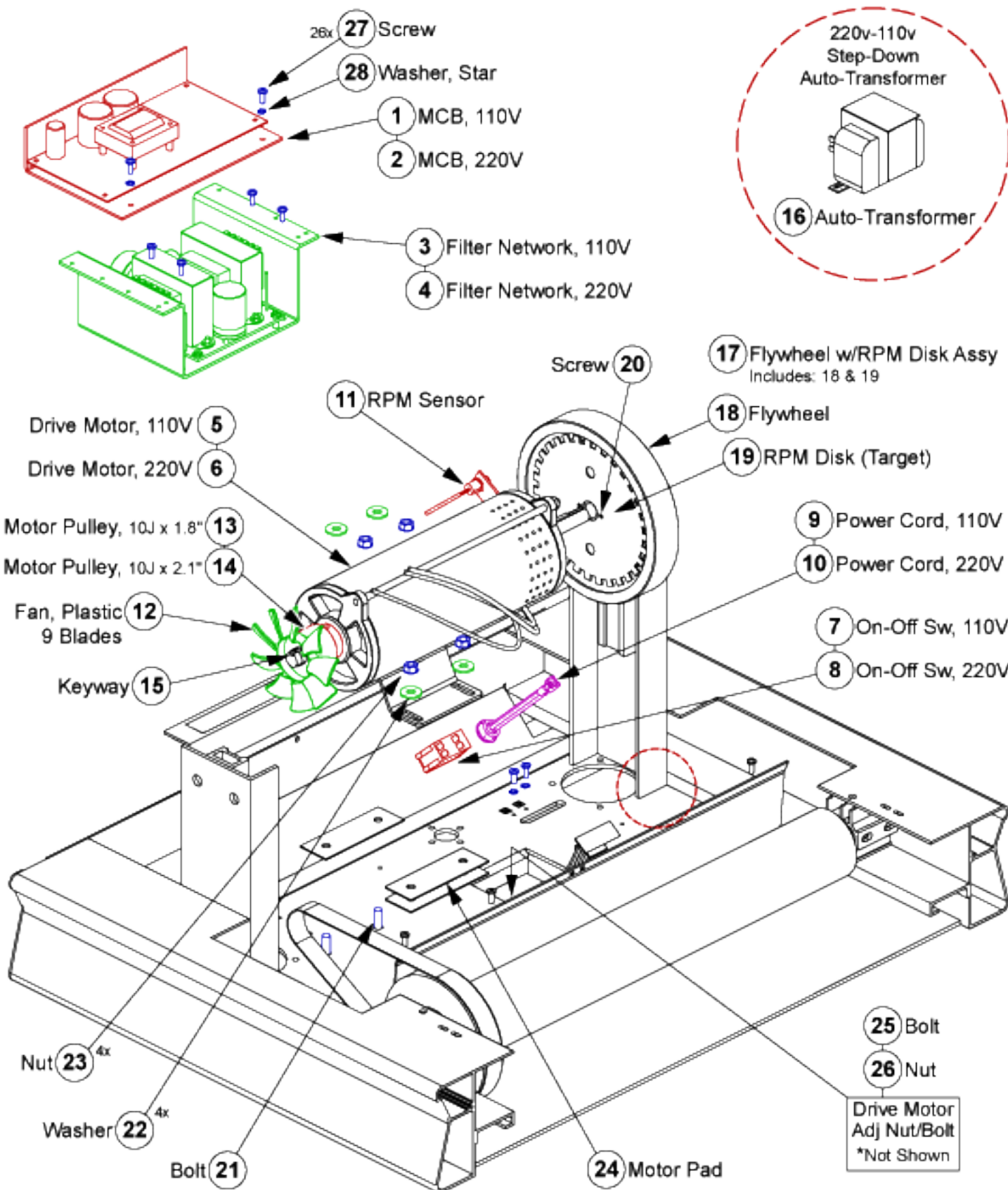

Elevation Assy

Serial Starting: Dxxxxx

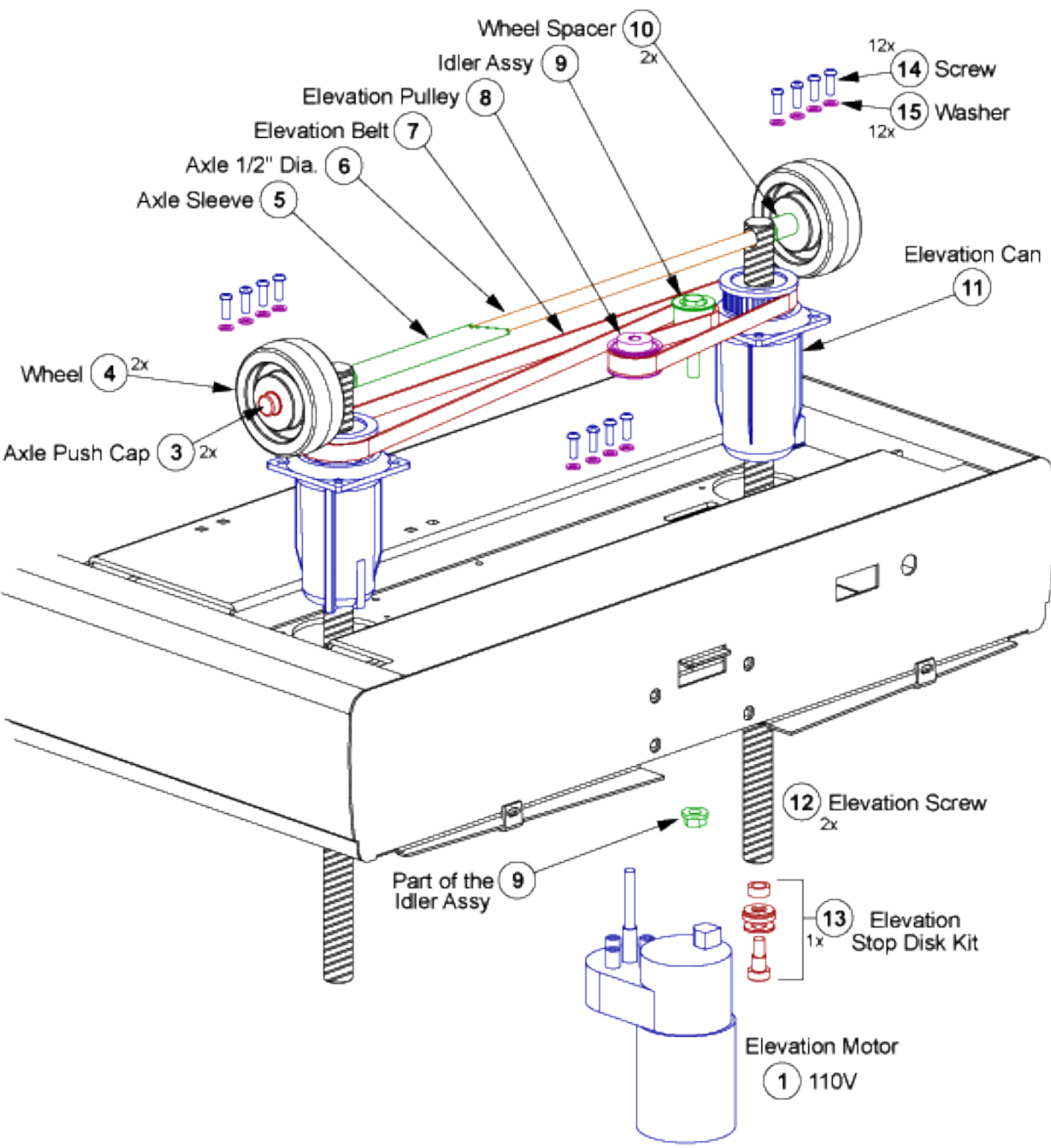

Frame Assy
Serial Starting: Dxxxxx

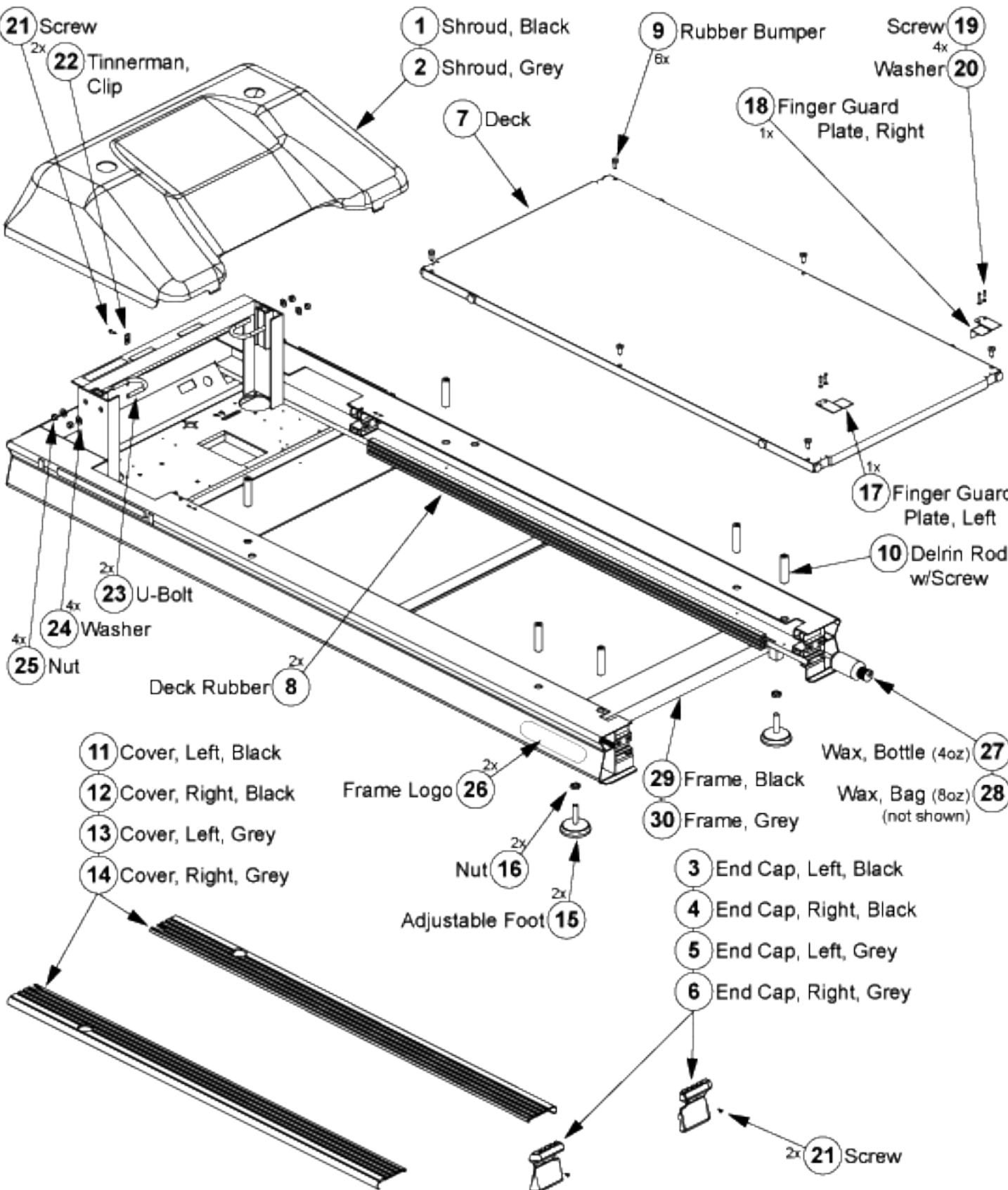

Handrail Assy

Serials Starting: Dxxxxx

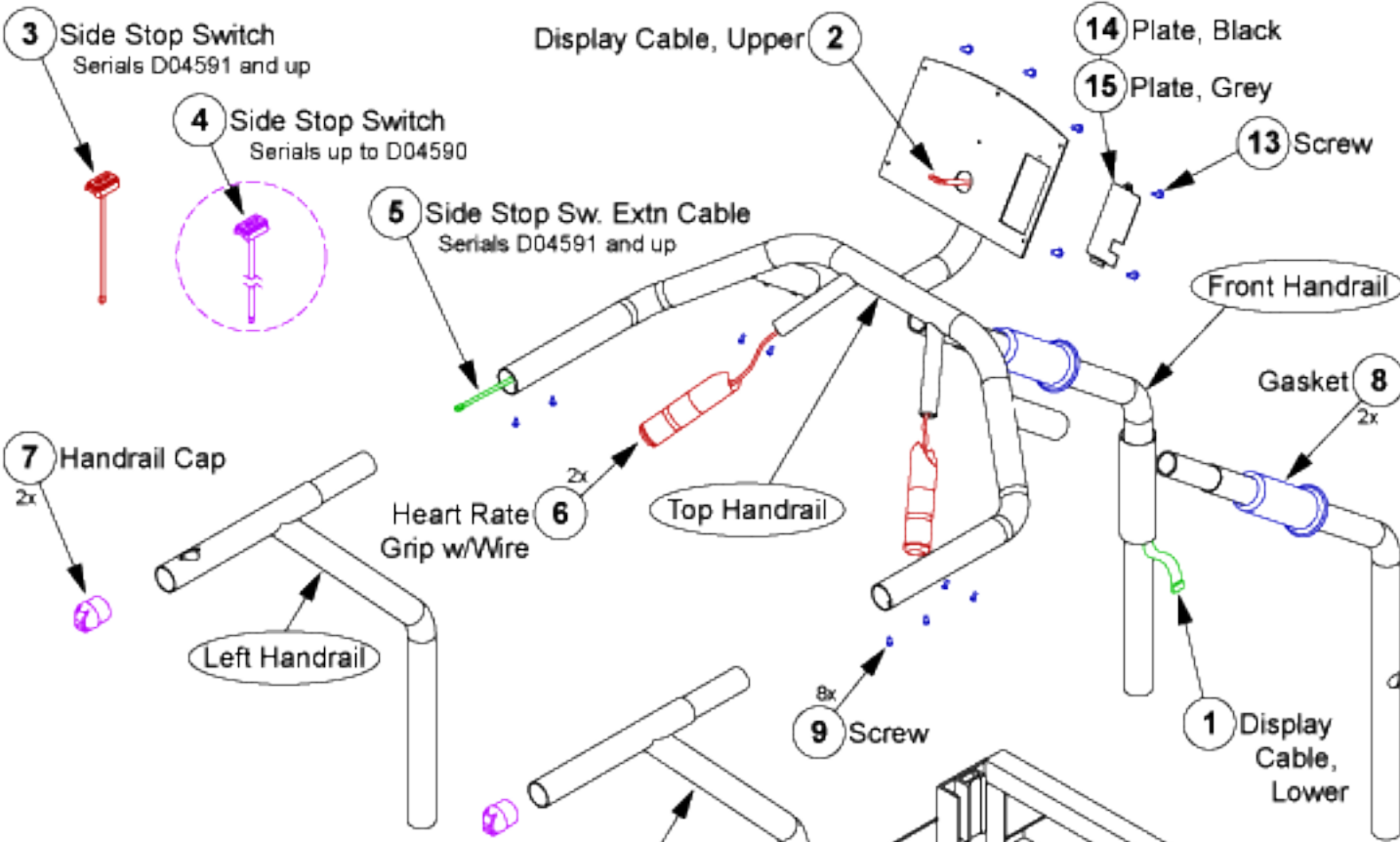

Top Handrail

- 16 Black w/Cont. Heart Rate
Serials D04591 and up
- 17 Grey w/Cont. Heart Rate
Serials D04591 and up
- 18 Black, no Heart Rate
Serials D04591 and up
- 19 Grey, no Heart Rate
Serials D04591 and up

Left Handrail

- 20 Black, w/Stop Switch Hole
Serials D04591 and up
- 21 Grey, w/Stop Switch Hole
Serials D04591 and up
- 22 Black, no Stop Switch Hole
Serials up to D04590
- 23 Grey, no Stop Switch Hole
Serials up to D04590

Right Handrail

- 24 Right, Black
- 25 Right, Grey

Front Handrail

- 26 Universal, Black
- 27 Universal, Grey

- 2x 12 Washer
- 2x 11 Washer, Cut
- 2x 10 Bolt, 6"

Running Belt Assy

Serial Starting: Dxxxxx

Important Running Belt Note:
 When installing a new waxable running belt onto a treadmill, you must be sure there is a fresh coating of wax on the deck surface. A new running belt must have this coating of wax. If not, your running belt will burn down the center and will not be covered under 90 day part warranty.

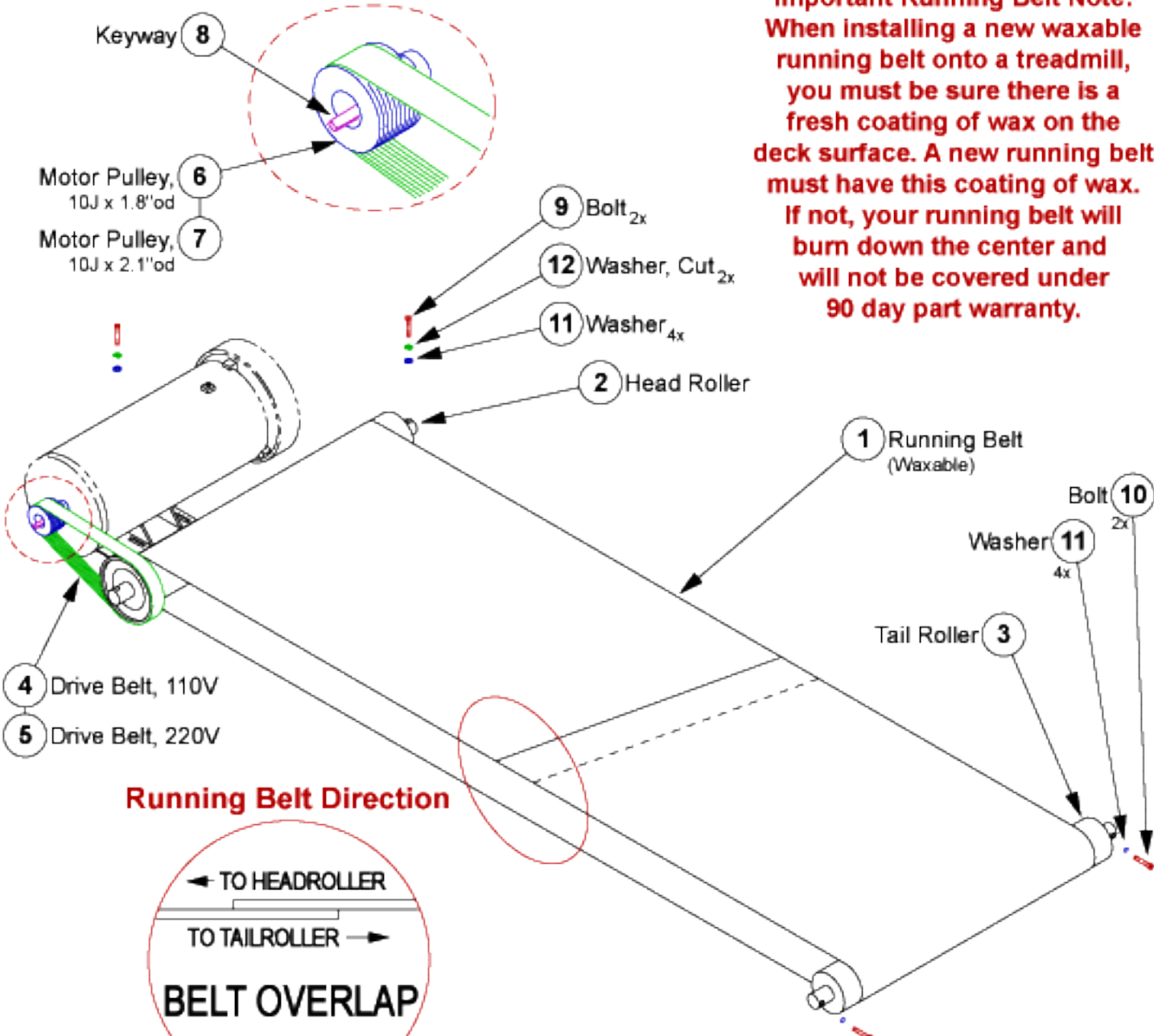

Running Belt Direction

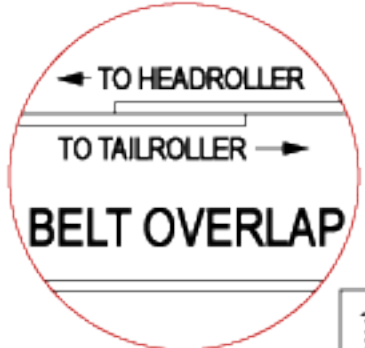

The running belt must travel in the direction shown here. If not the seam may tear and will not be covered under 90 day part warranty.

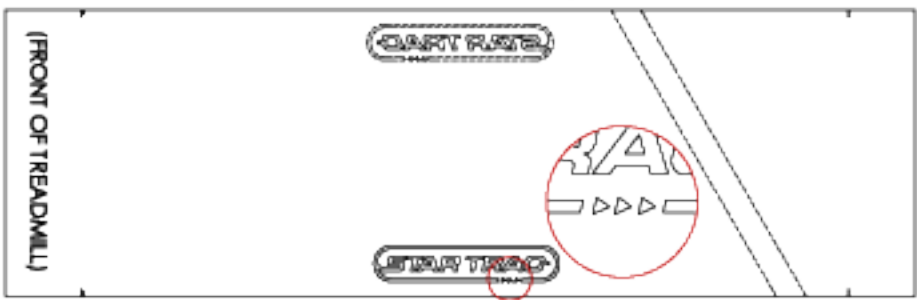

The arrows in the logo on a running belt can be used to identify the direction of travel.

Power Cord Assy's

9-xxxx-x**USA**xx

110V 220V



USA OUL		① Power Cord 110V NEMA 5-20		
	USA OUL JPN	② Power Cord 220V NEMA 6-15		
	OCE	③ Power Cord 220V CEE 7/7		
	AUS	④ Power Cord 220V Australia		
	UKI	⑤ Power Cord 220V BS1363 fused		
USA OUL		⑥ Power Cord 110V - Right Angle Plug NEMA 5-20rt		
	USA OUL JPN	⑦ Power Cord 220V - Right Angle Plug NEMA 6-15rt		
	UKI	⑧ Power Cord 220V - Right Angle Plug CEE 7/7		
USA		⑨ Power Cord, Home Units 110V NEMA 5-15		
USA		⑩ Power Cord, Home Units 110V - Right Angle Plug NEMA 5-15rt		

DO NOT MODIFY THE POWER CORD THAT CAME WITH YOUR TREADMILL. USE THE SAME TYPE. DO NOT USE A HOME MODEL PLUG ON A COMMERCIAL TREADMILL. CONTACT STAR TRAC FOR INFO.